

DREXEL UNIVERSITY EXCHANGE STUDENT FACT SHEET 2016-2017

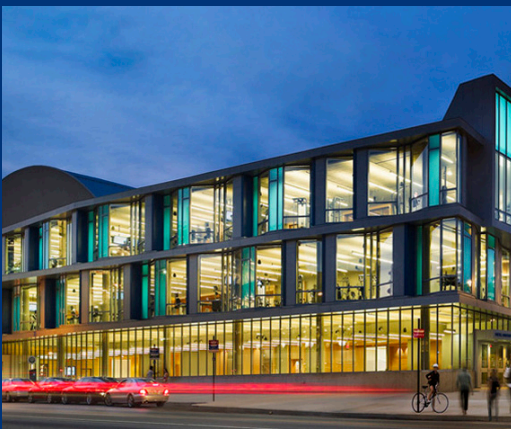

WHY PHILADELPHIA?

Philadelphia is the birthplace of the United States and its fifth most populous city. Situated halfway between New York City and Washington, D.C., Philadelphia is centrally located while possessing a distinctive character of its own. Rich in both history and innovation, Philadelphia is the only world heritage city in the United States, and Pennsylvania's economic center. Navigable by bus, subway, bicycle, or foot, Philadelphia offers endless opportunities to explore inspiring museums, exciting sports, live arts, and world class culture.

WHY DREXEL?

Drexel University is a private research institution ranked among the top 100 universities in the United States. Located in the University City section of Philadelphia, Drexel's campus is part of a thriving student and scholar community. Exchange students have access to wide variety of course options in a number of well-regarded academic programs, while co-curricular activities seek to provide further educational, social, and cultural opportunities.

WHO QUALIFIES?

Students who meet the follow qualifications:

- Minimum GPA 3.0
- English Language Proficiency tests*:

TOEFL iBT	80
IELTS	6.5
TOEFL CBT	214
TOEFL PBT	550
- Application materials submitted by deadline

WHAT'S THE PROCESS?

1. Apply to Drexel's exchange program via your home school's international office.
2. Receive an email from Drexel with login instructions for the online applications.
3. Complete the online application before the deadline.
4. We welcome you to Drexel!

*Drexel does not accept TOEFL ITP



COLLEGES AND PROGRAMS

College of Arts and Sciences

Anthropology
Biodiversity, Earth & Environmental Science
Biology
Chemistry
Communication
Criminal Justice
English
Geoscience
History & Politics
International Area Studies
Mathematics
Philosophy
Physics
Sociology

College of Nursing and Health Professions*

Behavioral Health
Counseling
Health Services
Administration
Health Sciences
Nutrition & Foods
Radiologic Technology
Invasive Cardiovascular Technology
Nursing

LeBow College of Business

Accounting
Business Analytics
Decision Sciences
School of Economics
Finance
General Business
International Business
Legal Studies
Management
Management Information Systems
Marketing

College of Computing and Informatics

Computer Science
Informatics
Information Technology
Information Systems
Computing and Security Technology

School of Education*

Elementary Education
Secondary Education

Westphal College of Media Arts & Design**

Animation and Visual Effects
Architecture*
Dance
Design & Merchandising
Entertainment & Arts Management
Fashion Design
Film & Video
Game Art & Production
Graphic Design
Interior Design
Interactive Digital Media
Music Industry
Photography
Product Design
Screenwriting & Playwriting
TV Production & Media Management
Westphal Studies

School of Biomedical Engineering, Science, & Health Systems

Biomedical Engineering

College of Engineering

Architectural Engineering
Chemical Engineering
Civil Engineering
Computer Engineering
Construction Management
Electrical Engineering
Engineering Technology
Environmental Engineering
Materials Science & Engineering
Mechanical Engineering

Center for Hospitality and Sport Management

Culinary Arts
Food Science
Hospitality
Tourism Management
Sport Management

Kline School of Law*

School of Medicine*

School of Public Health*

*Schools or programs may be closed to exchange students

**Students may have to submit a portfolio to be considered

**DREXEL'S
NUMBERS:**

16,986
undergrad
students

9,436
grad
students

**WE COME
FROM:** 48 states
102 countries

PRACTICAL INFORMATION

COURSES

- Undergraduate exchange students must take 12-20 course credits per quarter
- Students will be required to take at least 50% of their courses each term from within their assigned Drexel major
- Each student will be assigned to a Drexel academic advisor who will register them for classes
- Class selection is subject to course availability and fulfillment of pre-requisites



HOUSING

- On-campus housing is guaranteed for full-year (fall/winter/spring) students, but cannot be guaranteed for 1-2 term students
- Suite style and double-occupancy rooms are available
- Off-campus housing is also available. Students must arrange off-campus accommodations independently



MEALS

- Exchange students may participate in university dining plans, but they are not required to do so
- Students living in on-campus residence halls will have shared access to kitchen facilities
- There are a variety of restaurants and grocery stores near the university

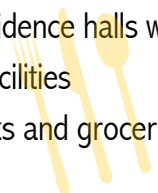

VISA

- All incoming exchange students are required to obtain a J1 Student Visa
- Drexel will issue a DS-2019 visa document to students upon acceptance



HEALTH INSURANCE & IMMUNIZATIONS

All exchange students must...

- Purchase Drexel's health insurance in order to meet US immigration health insurance requirement
- Pay a \$35 immunization fee
- Complete required immunizations



ESTIMATED BUDGET

Housing	\$2,000-\$4,000/quarter
Meals	\$1,000 - \$1,895/quarter
Books	\$500/quarter
Health Insurance	\$600 - \$900/quarter
Immunizations	\$35 (one-time fee)
Personal Expenses	varies
SEVIS & Visa Fees	\$450 (one-time fee)

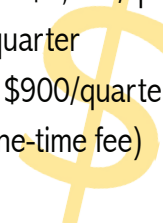

MORE INFO AT [DREXEL.EDU/STUDYABROAD/EXCHANGE](https://drexel.edu/studyabroad/exchange)

NOMINATION DETAILS

All exchange students must be nominated by their home institution to participate in the exchange program. If you have not yet been nominated, please contact your home school advisor.

Upon nomination, you will be prompted to complete the Drexel exchange student application. Upon your acceptance, you will be assigned a major at Drexel that most closely matches your home school major (see page 2 for a list of all majors). Each term at Drexel, you will be required to take 50% of your courses from within that major.

DEADLINES

	Nomination Deadline (from home school)	Application Deadline (materials recieved from student)
Fall term (Sept-Dec)	April 1	April 15
Winter term (Jan-March)	September 15	October 1
Spring term (March-June)	November 1	November 15

REQUIRED MATERIALS

Once you have been nominated, you will receive instructions via email about completing the online application. The following application materials will be required:

- J-1 Student form
- Official Transcript (in English)
- Financial support documentation (in English)
- Passport copy
- Inbound Exchange Application Form
- Official TOEFL/IELTS scores (if applicable)
- Preliminary course selections (at least 50% in your Drexel major)
- Portfolio (if applicable)

All materials may be submitted online (when applicable), via email to studyabroad@drexel.edu, or by mail by the above deadlines.

CONTACT US

For more information about exchange programs, contact:

studyabroad@drexel.edu

+1-215-571-3558

Office Address:

Paul Peck Problem Solving
& Research Center
101 N. 33rd St., Suite 201
Philadelphia, PA 19104

Other contacts:

Daniela Ascarelli
Director, Study Abroad
ascareld@drexel.edu
+1-215-895-6280

Mary Hagenbach

Inbound Exchange
Advisor
mth62@drexel.edu
+1-215-571-6372